

4.3"
(B043A)

INTERACTIVE PUSH BUTTON MEDIA PLAYER
OPERATING MANUAL



Please keep this operating manual for future reference

TABLE OF CONTENTS

1.INTRODUCTION.....2
2.SAFETY PRECAUTIONS.....2
3.FRONT, BACK AND SIDE VIEW OF PLAYER.....3
4.PLAYING.....3-4
5.AUTO DOWNLOAD FROM USB.....4
6.REMOTE CONTROL OPERATION.....5
7.SYSTEM SETUP.....6-7
8.SPECIFICATION.....8-9

1. Introduction

Before operating the player, please read this user manual thoroughly, and retain it for future reference. Please check unit package to confirm accessories.

Main Features

- (1) 4.3" TFT LCD panel with stereo output
- (2) SD card as storage and playback media
- (3) USB as auto download media
- (4) Playback mode: 2 playback modes
- (5) Power supply: 6 C-cell battery or DC power adaptor.
- (6) Important Notice: C-cell battery and power adaptor cannot be used at the same time. Otherwise there is a risk of burning the battery

Specifications are subject to change without notice.

2. Safety Precautions

- (1) The unit is for indoor use only.
- (2) To reduce the risk of fires or electric shock, do not expose the unit to rain or moisture.
- (3) Do not block the ventilation holes on the back of unit at any time.
- (4) Do not subject the unit to severe shocking
- (5) Prevent any foreign matter falling into the external slot.
- (6) Do not open the case of the unit. There is a risk of electric shock, and there are no user serviceable parts inside. Opening the case will void your warranty.

3. Front, back and side view of player

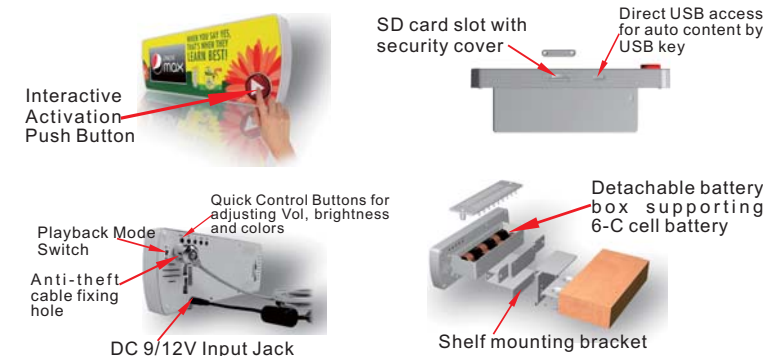

4. Playing

1) Playback Mode M1

- Put the playback mode switch at "M1"
- Save a "pop1" folder in the SD card and copy media files inside this "pop1" folder.
- Open the SD card security cover and insert SD card
- Once connected to power, the device will playback the media files in SD card for one time, after go to stand-by mode while the button keeps flashing; Once the button is pressed, the button stops flashing and all the media files in the SD card would be played for one time; After playback, the device would enter into the standby mode automatically again while the button is still flashing

4. Playing

2) Playback Mode M2

- Put the playback mode switch at "M2"
- Save 2 folders in the SD card, one named "pop1", the other one named "pop2", and copy media files inside the 2 folders.
- Open the SD card security cover and insert SD card
- Once connected to power, the button would be flashing and the device will play in loop the media files in folder "pop1". When press the button(button stops flashing), playback the media files from folder "pop2" for one time, and then go back to loop playback the media files in folder "pop1" with the button flashing.

5. Auto Download from USB

Add new files into SD card by Using USB

- (1) Set up a folder "pop1" and "pop2" in the USB key and put inside the folder the media files you want to update into the SD card.
- (2) When unit playing, insert USB into USB slot.
- (3) The new files stored in the USB would replace the old files stored in the SD card
- (4) After download finishes, please pull out the USB and the unit would playback new media files automatically.
- (5) If the playback mode is switched at "M1", there is still no problem to have a "pop2" folder in the SD card.

6.Remote control operation

	Power On/Off
MUTE	NO SOUND
PHOTO	Playback photo files
MUSIC	Playback music files
Movie	Playback video files
SETUP	Enter the SETUP menu
CALENDAR	Set up the CALENDAR
V+ V-	Volume Up / Volume Down
Fast Playback 2x, 4x, 6x, 8x / Fast Play forward 2x, 4x, 6x, 8x	
Pause / Stop / Enter	
Return to previous file / Advance to the next file	
Move the cursor up/down/left/right	

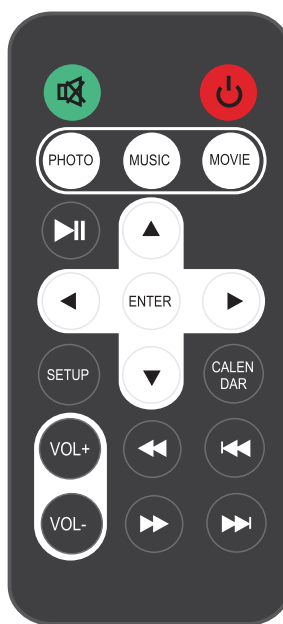

7. System Setup

Stop playing and press "SETUP" key on the remote control. Press UP/DOWN key to move the cursor

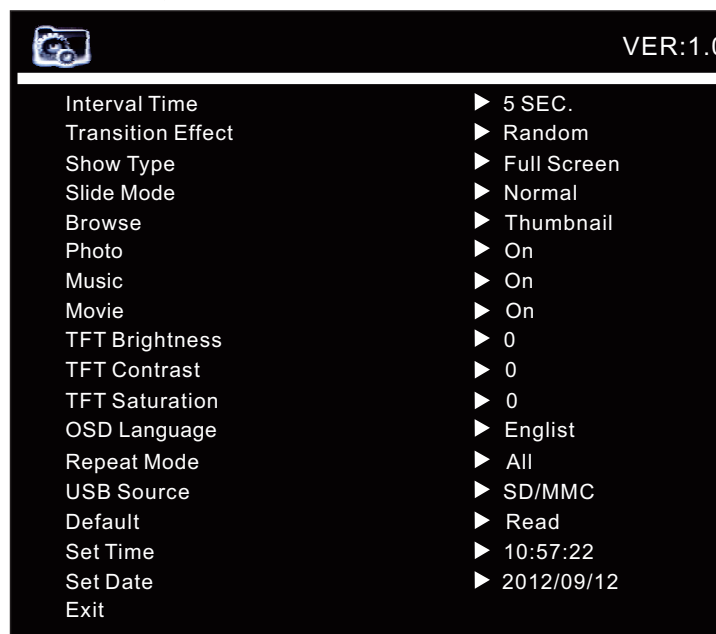

1) Interval Time (For photo display only)

Off, 5 Sec, 10 Sec, 15 Sec, 30 Sec, 1 Min, 3 Min

7. System Setup

2)Transition Effect (For photo display only)

Down, Bar Button UP, Rect Converge, Rect Spread, Rhombus, Compression, Cross Comb, Silk, Mask, Dissolve, Fade in Fade Out, Flip, Reel, Move Zoom, Random, No Effect, Blinde Horizontal, Blind Vertical, Color Ratio Hor, Color Ratio Ver, Expansion Hor, Expansion Ver

3) Show Type

Full Screen, Fit Screen

4) Photo

On/off

5) Music

On/off

6) Movie

On/off

7) TFT Brightness

-4 --- 4

8) TFT Contrast

-4 --- 4

9) TFT Saturation

-4 --- 4

10) OSD Language

English, Francaise, Deutsch, Italiano, Espanol, Portugues,

Nederlands, Polski

11) Default

Read

12) Set Time

Set up the clock display

13) Set Date

Set up the current date

14) Exit

8. Specifications

Panel Size	4.3"
Panel Resolution	480 x234
Storage and Playback Media	SD card
Auto Download Media	USB
Audio Output	L/R 1.5W
Power	6 x C cell battery or DC 9/12V input
Environmental	Operation temperature -20 to 70 degree
	Relative Humidity: 5%-95%(non-condensing)
Support Video Formats	MPEG1(VCD) File format: MPG/DAT/VOB Video Scale Size: Max 720X576 pixels (PAL), Frame Rate: up to 30fps, Bit rate: up to 8mbps, Audio Decode: MPEG-1/2 layer 1/ 2
	MPEG2(SVD) File format: MPG/DAT/VOB Video Scale Size: Max 720X480 pixels (NTSC), Frame Rate: up to 30fps, Bit rate: up to 8mbps, Audio Decode: MPEG-1/2 layer 1/ 2, LPCM
	MPEG4 File format: avi Video Codec: XviD/ DivX/ M4S2/ MP4S Video Scale Size: Max 720X576 pixels, Frame Rate: up to 30fps, Bit rate: up to 8mbps, Audio Decode: MPEG-1/2 layer 1/ 2/3, PCM,WMA
	M-J File format:avi Video Codec: XviD/ DivX/ M4S2/ Video Scale Size: Max 720X576 pixels (PAL), Frame Rate: up to 30fps, Bit rate: up to 8mbps, Audio Decode: MPEG-1/2 layer 1/ 2/3, PCM, WMA
	MP4S Video Scale Size: Max 720X480 pixels (NTSC), Frame Rate: up to 30fps, Bit rate: up to 8mbps, Audio Decode: MPEG-1/2 layer 1/ 2/3, PCM, WMA

8

8. Specifications

Support photo Formats	JPEG <i>Baseline</i> (444/ 440/ 422/ 420/ Grayscale)	Resolution: Up to 4 Mega-Pixels, File Size: 40MB, EXIF: Up to v2.2
	BMP OS/2 V1, Windows V3/V4/ V5	Resolution: Up to 20M Pixels, File Size: 40MB
Support Audio Formats	Mp3	Bit Rate: 32K ~ 320Kbps, Sampling Tag: 8K ~ 48KHz, ID3 Tag: No
	AAC LC	Bit Rate: Arbitrary bitrates, Sampling Tag: 8K ~ 96KHz, ID3 Tag: No
	WMA	Bit Rate: 5K ~ 192Kbps, Sampling Tag: 8K ~ 48KHz, ID3 Tag: No

9